

Door mount

HET200PB series

Dimension drawing

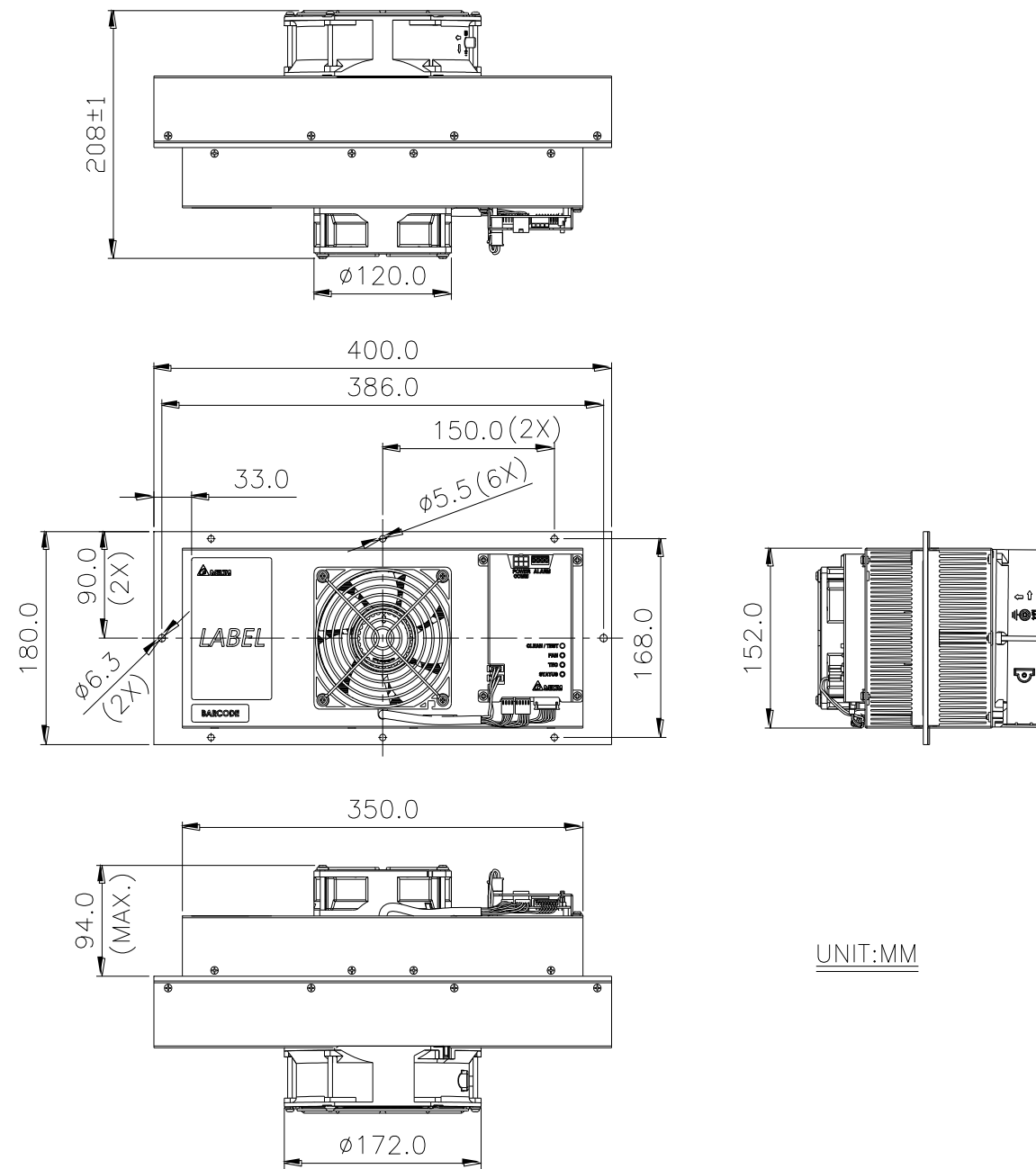

Features

- ◆ IP55 waterproof at external side
- ◆ FAN / TEC / Control fail alarm
- ◆ Clear LED status indicator
- ◆ Standalone temperature control
- ◆ High efficiency and reliable fan modules

Design

- ◆ High efficiency of cooling & Heating
- ◆ Thermal electric cooling module
- ◆ Rated voltage at 48V
- ◆ Built-in controller

Main feature	Unit	Model Number
		HET200PB
Outline dimension	mm	400 H x 180 W x 208 D
Weight	Kg	9.0 ± 0.5
Cooling capacity ($\Delta T = 0^{\circ}C$)	W	200
Heating capacity @-40° C	W	225
Rated voltage	VDC	48 (TYP.)
Operating voltage range	VDC	40-56
Actuality Current	A	5.9 (TYP.)
Power Consumption	W	283
Operating temperature	°C	-40-55
Internal airflow rate	CFM	100 (TYP.)
External airflow rate		120 (TYP.)
Acoustic noise at 1M :	dB-A	61.0 dB-A (Typ.)
(Sound pressure)		65.0 (Max.)

* Specifications are subject to change without notice.