

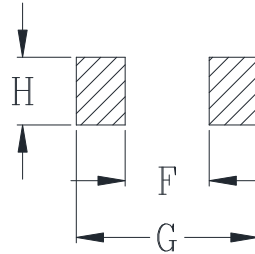

DELTA P/N : HCB0666 Series

Mechanical dimensions

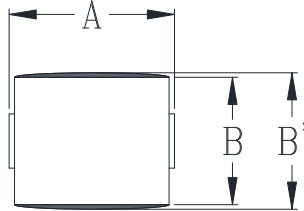

PCB LAYOUT

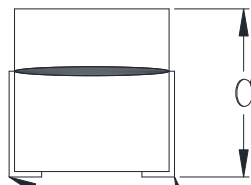

DCR measure point.

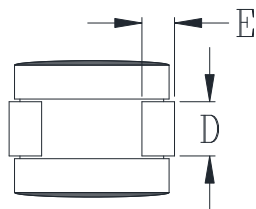

UNIT : mm

- A = 5.7 ± 0.3
- B = 4.7 ± 0.3
- B' = 5.3 MAX.
- C = 6.0 ± 0.6
- D = 2.0 ± 0.3
- E = 1.2 ± 0.3
- F = 3.1
- G = 6.5
- H = 2.5

Electrical Characteristics @ 25°C, 100kHz, 1V

Delta P/N	L ¹ (nH)	Li (nH) MIN.	DCR (mΩ)	Isat ² (A)			Ir ³ (A)
				25°C	100°C	125°C	
HCB0666-500	50	32	$0.24 \pm 7\%$	90	73	67	56

1. Tolerance of inductance : $\pm 20\%$.
2. Isat is the DC current which causes the inductance drop to Li.
3. Ir is the DC current which causes the surface temperature of the part increase approximately 40 °C .
4. Operation temperature: -40°C to 125°C (Self-temperature rise includes).